



中天道成

Success Way
Clean Tech

以专业技术和用心服务实现客户最大价值

Professional Technology and Excellent Service to Maximize Customer's Value

Turn-key Solution Provider for Cleanroom



中天道成

Success Way
Clean Tech

中天道成（苏州）洁净技术有限公司
Success Way Clean Technology Co., Ltd.

地址：苏州工业园区嘉瑞巷8号乐嘉大厦1幢2518-3015
Add.: Rm.2518,Block 1,Locca Tower,No. 8 Jiarui Lane,
Suzhou Industry Park
邮编(Postcode): 215028
电话(Tel.): 0512-67507365 67507727
传真(Fax): 0512-67507112 67507922
邮箱(Email): office@ztcleantech.com
网址(Website): www.ztcleantech.com

中天道成（苏州）洁净技术有限公司
Success Way Clean Technology Co., Ltd.



中天道成

Success Way
Clean Tech

中天道成（苏州）洁净技术有限公司
Success Way Clean Technology Co., Ltd.

目录 Catalogue

公司简介
Company Profile

公司资质
Company Qualification

净化工程
Purification Project

净化产品
Purification Product

公司业绩
Achievements

公司简介:

中天道成（苏州）洁净技术有限公司、深圳新科特种装饰工程苏州分公司坐落于中国最具创新活力的苏州工业园区，以不断创新、追求卓越的洁净技术和用户第一，质量至上的服务理念，为国内外用户提供洁净室及相关受控环境一站式整体解决方案。

公司拥有多名国内外知名的净化专家学者、高级工程师、留学归国人员和国内知名高校、研究院所毕业的研究生组成的研发设计团队和一大批具备丰富实践经验的施工人才队伍。依托中国电子工程设计院的技术优势，公司拥有建筑装饰工程设计甲级资质，建筑装修装饰工程专业承包一级资质、机电设备安装工程专业承包一级资质；并通过ISO9001、ISO14001和OHSAS18001质量、环境、职业健康认证，具有与国际接轨的管理体系。多年来连续被评为重合同守信用企业。

公司致力于微电子、纳米技术、精密测量、制药、生物安全实验室、医院手术室、ICU等洁净室及相关受控环境领域工程建设及相关配套净化产品的研究开发、生产制造和销售，为客户提供从工程咨询、工程设计、项目管理、设备采购、建造安装、调试验证，设施运行维护等全方位专业服务，用户遍布中国、美国、俄罗斯、尼日利亚、阿尔及利亚、哥伦比亚等十多个国家和地区，累计工程案例超过一千多项。



Company Profile:

Located in the most creative Suzhou Industry Park in China, Success Way Clean Technology Co., Ltd. Shenzhen Xinke(Suzhou) Special Decoration Engineering CO.,Ltd, provide domestic and overseas customers with one-stop packaged solution for cleanroom and relevant controlled environment.

We have a research and development team comprised of cleanroom experts and professors, senior engineers, graduates returned from abroad, and postgraduates from renowned universities and research institutes in China, and has a number of construction staff who have rich work experience. Based on the technical advantages of China Electronics Engineering Institute, we hold the qualifications of "Class-1 Building Decoration Engineering Design", "Grade-1 Building Decoration Engineering Contracting" and "Grade-1 Mechanical and Electrical Equipment Installation Engineering contracting" and certified by ISO9001, ISO14001 and OHSAS 18001 in respect of quality, environment and vocational health. We have awarded by government "Contract Abiding and Trustworthy Enterprise" for successive years.

We are committed to the design, development, construction, manufacture of cleanroom and relevant controlled environment applicable to micro-electronics, nanometer technology, precision measurement, pharmaceuticals, biosafety lab, operation theater, ICU, as well as the sales of relevant purification products. We can provide customers with comprehensive and professional services ranging from engineering consultation, engineering design, project management, equipment procurement, construction, installation, commissioning and validation, facility maintenance, etc. We have contracted more than 1000 projects in China and more than 10 countries, including America, Russia, Nigeria, Algeria and Columbia.

公司资质

Company Qualification





中天道成

Success Way
Clean Tech

中天道成（苏州）洁净技术有限公司

Success Way Clean Technology Co., Ltd.

全方位的服务能力

Comprehensive Service Ability

施工图绘制

Drawing-Making

生产采购发运

Production/Procurement/Shipment

现场施工

On-site Construction

调试运行

Commissioning

竣工验收

Complete Acceptance

检测认证

Test and Qualification

操作培训

Operation Training

概念设计

Conceptual Design

初步设计

Primary Design

深化设计

Detail Design

咨询

Consultation

规划

Planning

可行性分析

Feasibility Analysis

在中国，我们的累计工程项目超千项，连年被评为重合同守信用企业，在国外，我们用真诚和服务赢得了尊重，足迹遍布四大洲。

In China, we have contracted more than 1000 projects and awarded "Contract Abiding and Trustworthy Enterprise" for successive years. Outside China we won customers' respects with our sincerity and good services.

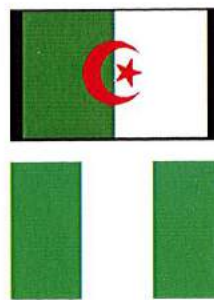

在深刻理解并掌握洁净室及相关受控环境各项标准，实现对工艺流程布局等规范化设计的基础上，借助Autodesk公司的BIM相关软件，在设计阶段就呈现出逼真的3D设计，在给用户提供最直观的认识的同时，更真实模拟现场的实际条件、空间管理与布局、重点难点的实施方案，协调各专业的交叉配合，避免了现场可能发生的冲突，大大提高了生产效率，降低项目成本。

With deep understanding of the codes of cleanroom and relevant controlled environments, to achieve reasonable design for process flow and layout, we adopt BIM 3-D software to have a visual presentation of completed project in the phase of design.

With BIM technology, we can have an optimized space management, the construction efficiency can be improved and the cost can be lowered.

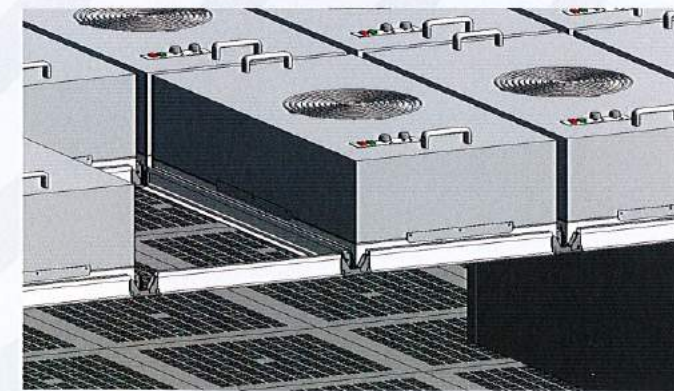
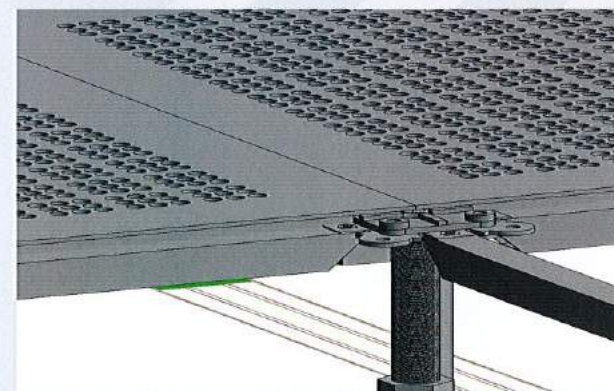
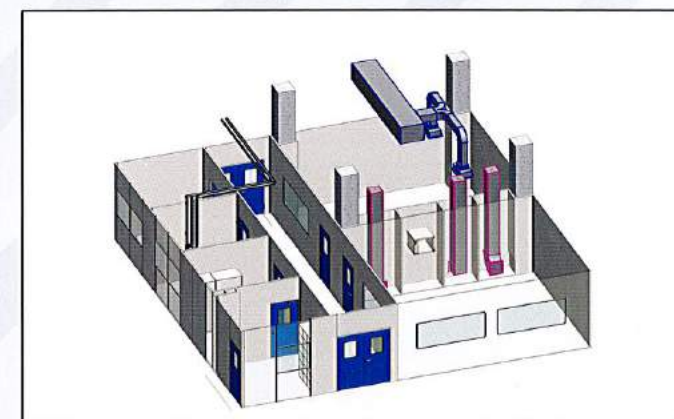
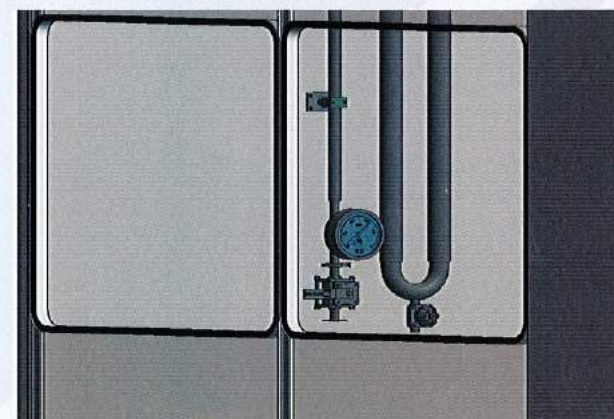
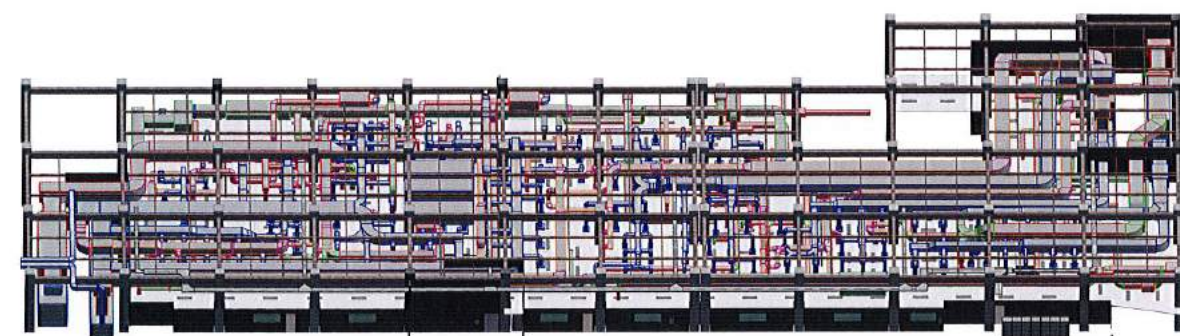



中天道成

Success Way
Clean Tech

中天道成（苏州）洁净技术有限公司

Success Way Clean Technology Co., Ltd.

符合国际标准的产品与服务

Products and Services in accordance with International Standards

公司技术人员主参编国家标准基本覆盖了中国洁净室及相关受控环境领域。同时积极参入国际标准化工作，公司的产品和服务符合美国cGMP、欧盟GMP、WHO等洁净室相关标准。

Our technical engineers involve in almost all national standards of China cleanroom and relevant controlled environment. Meanwhile, we actively participate in international standardization work. Our products and services can meet international standards like American cGMP, European GMP, WHO, etc.

序号	标准名称	标准号	类别
1	洁净室及相关受控环境 生物污染控制 第1部分 一般原理和方法	GB/T25916.1-2010	主编
2	洁净室及相关受控环境 生物污染控制 第2部分 生物污染数据的评估与分析	GB/T25916.2-2010	主编
3	洁净室及相关受控环境 第1部分 空气洁净度分	GB/T25915.1-2010	参编
4	洁净室及相关受控环境 第2部分 证明持续符合GB/T25915.1的检测与监测技术条件	GB/T25915.2-2010	参编
5	洁净室及相关受控环境 第3部分 检测方法	GB/T25915.3-2010	参编
6	洁净室及相关受控环境 第4部分 设计、建造、启动	GB/T25915.4-2010	参编
7	洁净室及相关受控环境 第5部分 运行	GB/T25915.5-2010	参编
8	洁净室及相关受控环境 第6部分 词汇	GB/T25915.6-2010	参编
9	洁净室及相关受控环境 第7部分 隔离装置（洁净风罩、手套箱、隔离器、微环境）	GB/T25915.7-2010	参编
11	洁净室及相关受控环境 第8部分 空气分子污染分级	GB/T25915.8-2010	主编
12	洁净室及相关受控环境 维护结构夹芯板应用技术指南	GB/T29468-2011	参编
13	洁净室及相关受控环境 性能及合理性评价	GB/T29469-2012	参编
14	洁净室及相关受控环境 第9部分 按粒子浓度划分表面洁净度等级	报批稿	主编
15	洁净室及相关受控环境 静电控制技术指南	报批稿	主编
16	洁净室及相关受控环境 检测技术分析与应用	报批稿	参编
17	医院负压隔离病房环境控制要求	报批稿	主编
18	医院洁净室应用规范 第1部分 总则	报批稿	主编
19	洁净室及相关受控环境 节能指南	报批稿	参编

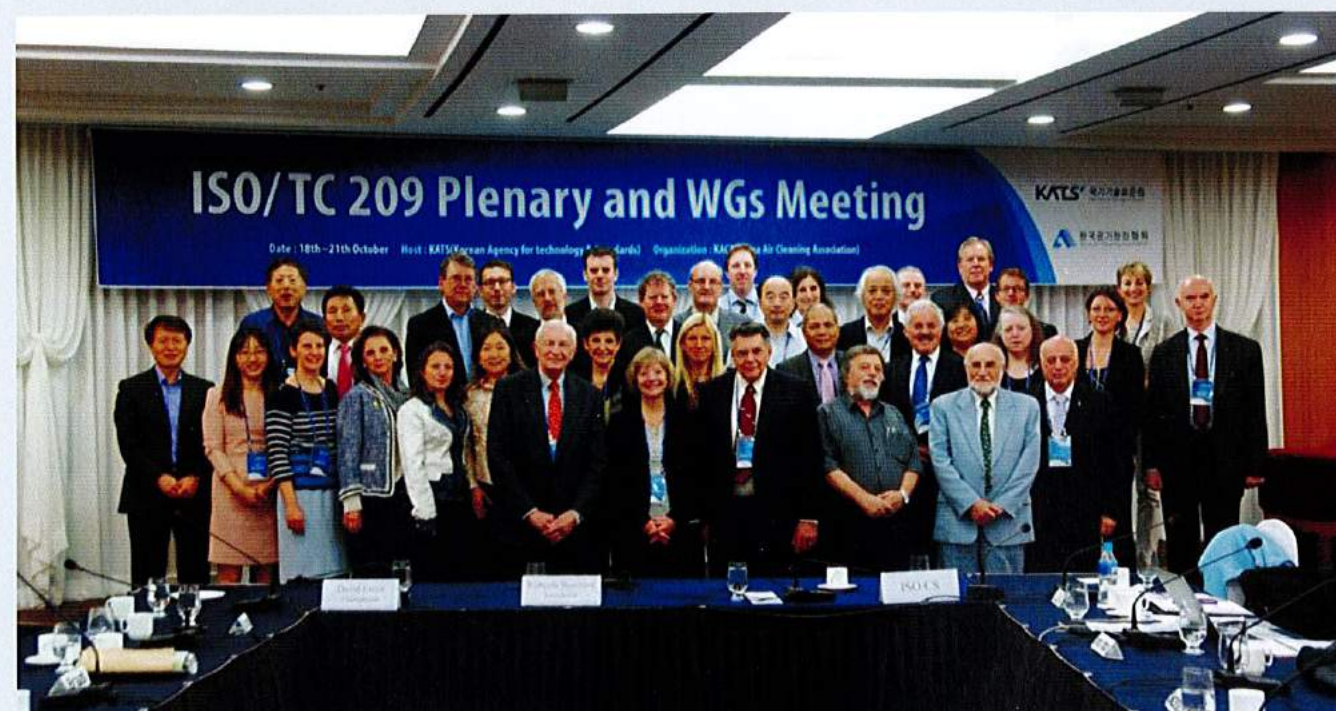

专业的检测设备，标准的检测方法，确保项目质量符合相关规范要求。

Professional Testing Instruments and Methods to Ensure Project Quality Conforms to Relevant Codes.



公司拥有美国ATI高效过滤器扫描检漏系统，可对扫描结果进行打印，避免高效过滤器安装不当

We have ATI Scanning leakage testing system for HEPA filter; the scanned results can be printed out. Avoid unfit installation of HEPA filter.



德图高精度温湿度计及微压差计，可准确测定洁净度环境指标。

"Testo" High-precision T&RH meter and micromanometer can accurately measure cleanliness class



公司拥有美国Lighthouse尘埃粒子计数器，28.3升/分钟到100升/分钟，可检查粒子粒径0.1-25微米

We have "Lighthouse" particle counter from USA, ranging from 28.3 L/min. to 100 L/min. It can measure the particle with 0.1-25 micrometer by diameter.



纯水烟雾发生器，可检测室内气流组织，保证洁净气流最优化，且不对洁净室造成污染

Pure-water Aerosol Generator can measure indoor air distribution, ensure the most optimized airflow and no contamination to cleanroom.



拥有美国TSI及法国KIMO的风量罩，准确调整洁净风量风速，确保系统稳定、经济运行。

Air Hood by American TSI and French KIMO, accurately adjusts air velocity and volume, ensure system running in a stable and economical way.



Validation Checklist			
No.	Check Item	Result	Page Number
1	Document Control		1
2	Scope of Work		2
3	Responsibility and Authority		3
4	Resources		4
5	Equipment		5
6	Qualification		6
7	Calibration		7
8	Methodology		8
9	Procedure		9
10	Execution		10
11	Documentation		11
12	Reporting		12
13	Conclusion		13
14	Approval		14
15	Revision		15
16	Summary		16
17	Final Review		17
18	Final Approval		18
19	Final Report		19
20	Final Conclusion		20
21	Final Summary		21
22	Final Review		22
23	Final Approval		23
24	Final Report		24
25	Final Conclusion		25
26	Final Summary		26
27	Final Review		27
28	Final Approval		28
29	Final Report		29
30	Final Conclusion		30

公司为客户提供DQ、IQ、OQ、PQ验证服务，承接的项目已有通过中国GMP、美国FDA、欧盟GMP和WHO认证的成功案例。

We can provide validation services of DQ, IQ, OQ, PQ and we contracted projects certified by China GMP, American FDA, European GMP and WHO.



中天道成

Success Way
Clean Tech

中天道成（苏州）洁净技术有限公司
Success Way Clean Technology Co., Ltd.

医疗净化

公司可为医疗净化单元主要包括：手术部、ICU、CCU病房、NICU病房、烧伤病房、血液病房、隔离病房、各类实验室、中心供应室、配药中心、生殖中心，DSA手术室、检验科等及医用气体工程、医疗信息化与智能化等提供咨询设计、建设实施、运行维护等一体化服务。

Medical Clenaning

We can provide a packaged services ranging from consultation, design, construction to maintenance for medical cleaning units, such as operation theater, ICU, CCU ward, NICU ward, burn ward, blood ward, isolation ward, various labs, center supply center, drug dispensing center, reproductive center, DSA operation theater, test center, as well as medical gas project, medical Informatization and intelligentization.

公司开发出了节能型模块化洁净手术室，将手术室结构系统、空调系统、自动控制系统、监控系统、医用气体系统、电力系统等全部模块化整合，全部工厂生产，只需现场拼装，在保证质量，缩短工期的情况下，大大降低了建造费用和运行费用。

We have developed an energy-saving modular operation theater, comprising structure system, HVAC system, auto-control system, monitoring system, medical gas system, and electric system. All systems are modular type, that is, all components are fabricated in factory and assembled on site, so that the construction cost and running cost can be lowered sharply.

手术室智能控制系统

远程监控管理系统可实现系统温湿度、风量、压差梯度的自动调节及各种安全保护、联锁、节能运行等控制功能，以最大限度地保持手术室及病房接近无菌的环境，减少创伤感染，为医务人员创造最佳工作环境。针对不同类型空调系统及热湿处理方案，灵活采取最优控制策略；

Intelligent Control System of Operation Theater

Remote Monitoring Management System can conduct automatic regulation on humidity, temperature, airflow, differential pressure and control on safety protection, interlocking, energy saving, so as to keep operation theater as sterile as possible, cut down on contamination of wound and keep an excellent work environment for medical staff. For different type of air conditioning system and heat and humidity handling plans, the optimized control method can be flexibly adopted.

通过手机 APP 远程控制手术室的开启、关闭、手术室级别切换等功能。查看手术室内环境实时数据；查看手术室各系统及机组运行情况；接收系统报警信息，并及时维护。

With App on mobile phone, the operation theater can be remotely controlled, e.g. start and stop the theater, switch the theater from one cleanliness class to another one, check the running state of every system and unit, receive system alarming information and conduct maintenance on time.



手术室

Operation Theater (OT)



无拼缝结构手术室
Seamlessly-structured OT



大圆弧结构手术室
Big-arc structured OT



小八角结构手术室
Small Octagonal Structured OT



大八角结构手术室
Big Octagonal Structured OT



负压隔离手术室
Negative Pressure Isolation OT



杂交手术室
Hybrid OT



中天道成

Success Way
Clean Tech

中天道成（苏州）洁净技术有限公司

Success Way Clean Technology Co., Ltd.

手术室.病房

Operation Theater (OT)



ICU



医学检验实验室
Medical Test Lab



麻醉苏醒室
Anesthesia Recovery Room



儿童病房
Children Ward



负压隔离病房
Negative Pressure Isolation Ward



监控室
Monitoring Room



洁净走廊
Clean Corridor



功能插口面板
Functional Plug-in Panel



洗手池
Hand-Washing Sink



中天道成

Success Way
Clean Tech

中天道成（苏州）洁净技术有限公司

Success Way Clean Technology Co.,Ltd.

制药、食品行业

Pharmaceuticals and Food Industries

公司拥有丰富的制药及食品行业洁净室设计、施工、管理经验，协助客户建造符合中国GMP、美国cGMP、欧盟GMP、WHO规范要求的药厂设施，项目种类涉及中药制剂、原料药、无菌药品、生物制剂及血液制品等。公司拥有先进的加工设备和完善的检测仪器，为用户提供从设计到运行的全过程验证服务。

We have rich experiences in the design, construction and management of cleanroom applied to the pharmaceutical and food industries. We can assist customers in constructing pharmaceutical facilities which can conform to China GMP, American cGMP, European GMP and WHO standard. The cleanroom in pharmaceuticals covers crude drug, biological agent and blood product, etc. We have advanced process equipment and test instruments, and we can provide complete validation service from design to running.





中天道成

Success Way
Clean Tech

中天道成（苏州）洁净技术有限公司

Success Way Clean Technology Co., Ltd.

生物安全实验室

Biosafety Lab

生物安全实验室是通过防护屏障和管理措施，达到生物安全要求的微生物实验室和动物实验室，是传染性疾病预防控制、科学研究和诊断治疗的重要技术平台。生物安全实验室洁净系统的重点是维护结构的严密性和负压控制，在控制污染的同时不带来二次污染。与净化相关的主要有BSL-2、BSL-3、BSL-4级生物安全实验室。

Biosafety Lab (BSL) normally refers to microorganism lab and animal lab which can meet the requirements of biological safety by means of protective shield and management measures. It's also a very important technical platform to protect and constrain infectious disease, conduct research, diagnosis and treatment. The importance of cleanroom system of biosafety lab lies in the air tightness of structure and negative pressure control, and don't bring about secondary contamination while constrain it. The biosafety lab (BSL) is mainly classified as BSL-2 and BSL-3. BSL-4 in air purification field.



实验动物环境设施

Experimental Animal Facility

实验动物广泛应用于生命科学、人类医药和健康研究领域。公司可提供普通环境、屏障环境、隔离环境的设计、施工与运营维护，并提供相关动物笼具、独立通气笼盒等配套产品。公司协助业主对屏障环境、隔离环境按cGMP标准进行认证，保证实验动物功能环境和福利。

Experimental animal is used in the fields of life science, medical and health research. We can provide the design, construction and maintenance of common environment, shield environment, isolation environment, as well as the relevant products like animal cage, independent ventilation cage or box. We can assist customer in validating shield environment and isolation environment according to cGMP to ensure functional environment and welfare of experimental animals.





中天道成

Success Way
Clean Tech

中天道成（苏州）洁净技术有限公司

Success Way Clean Technology Co., Ltd.

太阳能/电子及微纳制造

Solar Energy/Electronics/ Micro-Nano Manufacture



洁净彩钢板系列

Sandwich Panel Series

由于其表面不产生易清洁、强度较高、防火性、隔音绝热性能好等优点，且结构简单且安装方便，广泛应用于食品、制药、电子、太阳能电池等行业净化厂房和科研、卫生等净化实验室的围护结构系统和吊顶系统。

Sandwich panel is characterized by no dust collection, high strength, fire proof, sound and heat isolation, simple structure and easy installation. It's widely used as wall and ceiling panel in cleanroom applicable to food, pharmaceutical, medical, electronic, solar energy industries, science research lab.

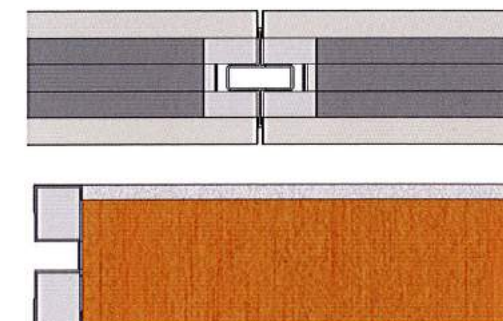

上表面材质：普通彩涂板、防静电彩涂板、耐化学腐蚀彩涂板、不锈钢、PVC等

Upper Surface Material: common color steel, anti-static color steel, corrosion resistance color steel, stainless steel, PVC. Etc.

夹芯材料：硫氧镁、岩棉、玻纤、纸蜂窝、铝蜂窝、聚氨酯等，根据承载力和防火极限等性能要求，可采用多种芯材组合方式，满足性能要求

Core Material: magnesium, rockwool, glass fiber, paper and aluminum honeycomb, PU, etc. Combined core materials can be adopted to meet the requirements of load and fire resistance.

下表面材质：可与上表面材质不同

Lower Surface Material: It can be different from upper surface

标准宽度：985mm、1185mm

Standard Width

标准厚度：50mm、100mm

Standard Thickness

尺寸根据需要定制

Dimension can be customized



注：彩钢板在使用时需选用与之配套的型材，具体技术细节请联系公司技术人员。

Note: Different sandwich panel has different profiled material. For details, please contact our technical personnel.



中天道成

Success Way
Clean Tech

中天道成（苏州）洁净技术有限公司

Success Way Clean Technology Co., Ltd.

洁净门系列

Cleanroom Door Series

根据洁净室功能需要，可制作钢板门、铝合金门及不锈钢材质门，可配隐藏式门铰链、隐藏式闭门器及隐藏式电子连锁，门体及门框特殊密封结构可满足GMP要求。门的结构形式有单门、子母门及双门等。门上根据需要配双层或单层玻璃密闭观察窗。

Steel door, aluminum door and stainless steel door are available according to cleanroom functions; concealed door hinge, concealed door closer and interlocked device are optional. Door structure type includes single door, unequal double door and double door. Double glass and single glass are optional to be mounted in door as sight window.



门标准高度：2100mm

Standard Height (SH):

单门标准宽度：900mm

Single Door Standard Width

子母门标准宽度：1500mm

Unequal Door Standard Width

双门标准宽度：1800mm

Double Door Standard Width

表面材质：钢板喷塑、不锈钢

Surface Material: Power-coated Steel Plate, Stainless Steel

选配件：机械门锁、把手；电子连锁，闭门器、
门下密封条

Optionals: Mechanical lock, handle, electronic interlocking
device, door closer, door seal.



注：具体规格可按需定制，特殊用途如防静电、屏蔽功能须事先申明

Note: The door can be customized if you have special requirement like anti-static, shield functions, etc.

洁净窗系列

Cleanroom Window Series

采用特殊的型材结构，与彩钢板围护连接方便并与其厚度一致，满足GMP表面平整性要求。洁净窗四周采用密闭结构，并预先放置干燥剂，避免内部有水雾现象发生。结构形式有圆角、直角，并可根据结构整体需要，在满足功能需求的同时，实现美观的效果。

Special profiled material, easy connection and flush with wall panel, conforms to GMP's requirement. Cleanroom window adopts airtight design, pre-set desiccant inside to prevent damp. Right angle and round angle are available.



注：窗的尺寸规格需与项目实际情况确定

Note: The window dimension can be determined according to specific conditions of project

洁净室地面材料系列

Cleanroom Flooring Material Series



环氧地面：

主要应用于制药、食品、医疗行业洁净室。厚度一般为2-3mm

Epoxy Floor: used in pharmaceutical, food, and medical industries; Thickness: 2-3mm



洁净室专用不锈钢洁净地漏
Dedicated S.S Floor Drain in
Cleanroom



PVC地面

主要应用于制药、电子、医疗净化相关行业，美观大方，施工方便，特别是上翻墙体施工，有效防水隔水。一般厚度2-3mm

PVC Floor

Mainly used in pharmaceutical, electronic, and medical industries; it's characterized by good look, easy construction, water proof. Thickness: 2-3mm



高架地板：

开孔率0-50%

主要用于垂直流送风方式的洁净室回风，根据行业需要可选防静电、耐腐蚀、高承重等功能。

Raised Floor

Hole Rate: 0-50%; Mainly used for return air in vertical supply mode. Anti-Static, corrosion-resistance, heavy load-bearing functions are optional for different industry.



中天道成

Success Way
Clean Tech

中天道成(苏州)洁净技术有限公司

Success Way Clean Technology Co., Ltd.

过滤器系列

Filter Series



粗效过滤器

滤料材质: 无纺布
过滤效率: 40% (计重法)
用途: 组合式空调箱初级过滤

Coarse Filter

Filter Material: Non-Woven Fabric
Efficiency: 40% (Arrestance)
Use: serve as pre-filter in AHU



F5/F6中效袋式空气过滤器

滤料材质: 无纺布
过滤效率: 40%-70% (比色法)
用途: 组合式空调箱中级过滤

F5/F6 Medium Eff. Bag-type Filter

Filter Material: Non-Woven Fabric
Efficiency: 40%-70% (Dust-spot)
Use: serve as medium filter in AHU



F5/F6中效袋式空气过滤器

滤料材质: 玻璃纤维
过滤效率: 85%-95% (比色法)
用途: 制药、食品、电子行业普通空调通风系统

F5/F6 Medium Eff. Bag-type Filter

Filter Material: Glass Fiber
Efficiency: 85%-95% (Dust-spot)
USE: applied in HVAC system of pharmaceuticals, food, electronic industries.

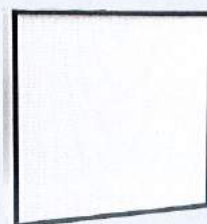

高效过滤器

滤料材质: 玻纤滤纸
过滤效率: 99.99% (0.3μm 计数法)
用途: 制药、食品、电子等行业洁净室末端过滤

HEPA Filter

Filter Material: Glass Fiber Filter Paper
Efficiency: High Efficiency 99.99% (0.3μm Particle Efficiency)
Use: serve as terminal filter of cleanroom applied in pharmaceutical, food, electronic industries.

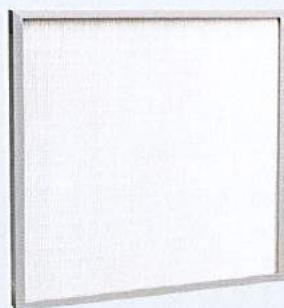

超高效过滤器

滤料材质: 玻纤滤纸
过滤效率: 99.9995% (0.1-0.2μm 计数法)
用途: 制药、微电子、半导体、纳米等行业高洁净度场所

Ultra Low Penetration Air Filter (ULPA)

Filter Material: Glass Fiber Filter Paper
High Efficiency 99.9995% (0.1-0.2 μm Particle Efficiency)
Use: Used in high cleanliness area like pharmaceuticals, microelectronics, semiconductor, nanometer, etc.

注: 以上产品具体规格请联系公司技术人员

Note: For specific specification of the above products, please contact our technical personnel.



耐高温高效过滤器

滤料材质: 超细玻纤滤纸
过滤效率: 99.99% (0.3μm 计数法)
用途: 工作温度350℃, 主要用于高温洁净烘箱

Temperature Resistance HEPA Filter

Filter Material: Ultra-fine glass fiber filter paper.
High Efficiency 99.99% (0.3 μm Particle Efficiency)
Use: Work temperature 350℃, mainly used in high temperature oven



化学过滤器: 也称活性炭过滤器, 具有表面积大、吸附能力强的特点。可吸附特定的气体, 如酸性气体 (H₂S)、碱性气体 (NH₃) 等, 广泛应用于半导体、微电子行业以去除分子污染和实验动物房中的气味处理。

Chemical Filter: also active carbon filter, characterized by big surface, strong absorption ability. It can absorb specific gas, e.g: acid gas (H₂S), caustic gas (NH₃), widely used in semiconductor, microelectronics industries to remove molecular contamination and smell from animal lab.

洁净室末端设备

Cleanroom Terminal Device

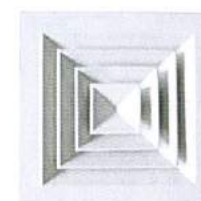

方形/圆形送风散流器

材质: 铝合金
主要应用于洁净室普通区域的送风

Square/Round Supply Diffuser

Material: Aluminum
Mainly used for air supply in common area

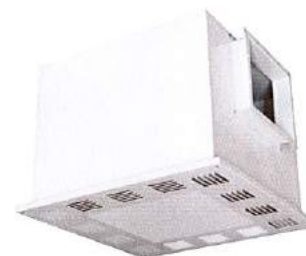

高效送风口

材质: 不锈钢、钢板喷塑
可配DOP检测口
可配液槽密封

HEPA Supply Inlet

Material: Stainless Steel, Powder-coated
Steel Plate DOP measuring port is optional
Liquid-channel sealing is optional

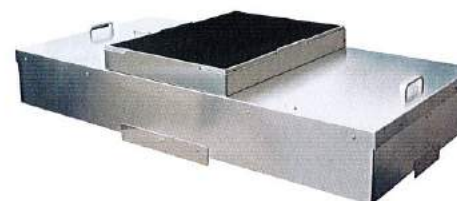

Fan Filter Unit (FFU)

有直流电机和交流电机可选
3-5挡调速, 可实现群控
主要用于制药洁净室内局部ISO5级高洁净度区域或微电子行业ISO5级以上洁净室

Fan Filter Unit (FFU)

AC and DC motor are available, 3-5 stage speed regulation, mainly used in local ISO 5 area or over ISO 5 cleanroom in microelectronic industry

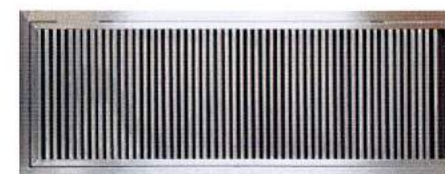

回风口

材质: 不锈钢、铝合金、喷塑钢板
用于洁净室回风, 表面与维护结构齐平, 满足GMP要求



Return Air Outlet

Material: Stainless Steel, Aluminum, Powder-coated Steel Sheet
Used for return air in cleanroom, flush with wall panel, conforms to GMP.



中天道成

Success Way
Clean Tech

中天道成（苏州）洁净技术有限公司
Success Way Clean Technology Co., Ltd.

风淋室系列

Air Shower Series



主要用于电子厂房洁净室出入口的人流和物流净化，具体尺寸需按照工厂实际的人流量或货物尺寸确定
Mainly used in electronic plant at entrance and exit for people and material flow. The specific dimension can be determined according to material dimension and the number of worker

传递窗系列

Passbox Series



普通传递窗
洁净传递窗
洁净传递仓
过氧化氢灭菌传递窗
内壁材质：不锈钢
外壁材质：不锈钢、钢板喷塑
洁净传递窗洁净度：ISO5级
自净时间：小于5分钟
可选配紫外灯杀菌



Common Passbox
Clean Passbox
Clean Pass-Through
Sterilizing Passbox
Internal Material: Stainless Steel
External Material: Stainless Steel, Powder-Coated Steel Plate
Cleanliness Class: ISO 5
Self-Cleaning Time: less than 5 min.
UV. Light Sterilizing is optional



洁净工作台系列

Clean Bench Series

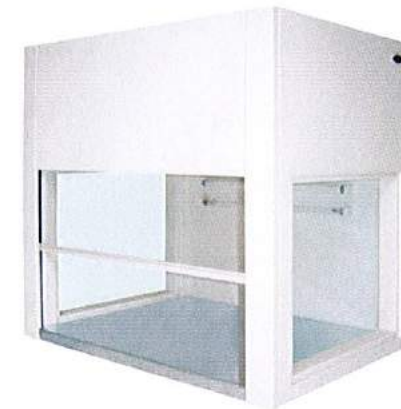

桌面型净化工作台

小巧方便，可放置与试验台上，实现局部最高ISO5级净化

Table-type Clean Bench

Small and Convenient, can be placed on experimental table, achieve local ISO5 area.



标准水平流型净化工作台

净化级别：ISO5
噪音 $\leq 65\text{dB (A)}$
气流速度 $\geq 0.35\text{m/s}$ （可调）

Standard Horizontal Flow Clean Bench

Class: ISO5
Noise: $\leq 65\text{dB (A)}$
Flow Velocity: $\geq 0.35\text{m/s}$ (adjustable)



标准垂直流型净化工作台

净化级别：ISO5
噪音 $\leq 65\text{dB (A)}$
气流速度 $\geq 0.35\text{m/s}$ （可调）

Standard Vertical Flow Clean Bench

Class: ISO5
Noise: $\leq 65\text{dB (A)}$
Flow Velocity: $\geq 0.35\text{m/s}$ (adjustable)



生物安全柜系列

Biosafety Cabinet Series



适用范围

生物安全柜是用于生物安全实验室或其他实验室的生物安全隔离设备，用于对人员、受试样本及环境进行保护，能满足危险度等级为1、2、3、级的病原体操作。

性能特征

- 1、箱体选用优质SUS304不锈钢或冷轧钢板，易清洁；
- 2、垂直层流负压机型，回流空气30%/100%过滤排放；
- 3、负压设计，保证操作人员安全；
- 4、一体化滑动安全移门定位，易于操作；
- 5、配备过滤器阻塞报警，送风机过载报警，工作窗开启限位报警系统。

Applicable Scope

Biosafety Cabinet is an isolation equipment used in biosafety lab or other lab. It can protect personal, testing sample and environment and can conduct operation of pathogen with risk rate of Class1,2 and 3.

Feature

Case is made of SUS 304, or cold-roll steel sheet, easy cleaning
Vertical laminar flow negative pressure, return air 30%/100% exhausted
Negative pressure design, ensuring personnel 's safety
Front sliding door and positioned easily
Equipped with filter block alarming, supply fan overload alarming, positioning alarming of sliding door.

主要技术参数

Main Technical Data

洁净等级 Cleanliness Class	ISO5 (100 级) / ISO4(10 级)
下降气流平均流速 (m/s) Down-flow Avg.Flow	0.25-0.5m/s
流入气流平均流速 (m/s) Inflow Avg. Flow	≥0.5m/s
噪声 Noise	≤67dB(A)
振动半峰值 Vibration Half-Peak Value	≤5um
气流平衡生物防护 Air Balance Biological Protection	人员保护 1-8CFU/ml (重复 3 次 , 5min/次) Personnel Protection 1-8CFU/ml (Repeat 3 times, 5 min/time) a. 撞击式采样器的菌落总数 : ≤10CFU/次 Impact Sampler' s colony lump-sum: ≤10CFU/times b. 狭缝式采样器的菌落总数 : ≤5CFU/次 Slot-type Sampler' s colony lump-sum: ≤5CFU/times 产品保护 1-8CFU/ml (重复 3 次 , 5min/次) 菌落总数 : ≤5CFU/次 Product Protection 1-8CFU/ml (Repeat 3 times, 5 min/time) colony lump-sum: ≤5CFU/times 交叉污染保护 1-8CFU/ml (重复 3 次 , 5min/次) 菌落总数 : ≤2CFU/次 Cross-contamination Protection 1-8CFU/ml (Repeat 3 times, 5 min/time) colony lump-sum: ≤2CFU/times



中天道成

Success Way
Clean Tech

中天道成（苏州）洁净技术有限公司

Success Way Clean Technology Co., Ltd.

制药厂洁净设备

Purification Equipment in Pharmaceuticals



称量间是一种用于制药、微生物研究和科学实验等场所专用的局部净化设备，广泛应用于原料的称量和计量，抗生素取样，激素类药品的处理，不论药品是粉末还是液体。

称量间将空气经初效过滤器、中效过滤器，由离心风机压入静压箱，再经高效过滤器后将气流扩散至出风面吹出，形成垂直单向气流，以保护操作人员及防止药品污染。称量罩的操作区域排出10%的循环空气，维持负压状态，以避免污染环境及药品交叉污染。

设计参考依据：

中国GMP（2010版）标准

欧盟GMP标准

FDA法规及最新cGMP指导方针

安装有压差表，监控过滤器的使用状况；加装DOP测试口，可有效对高效过滤器的完整性进行检测；

Weighing Booth is a purification device used in pharmaceuticals, microorganism research and scientific lab, serving to weight and test of raw material, sampling of antibiotic, handling of Hormone-Effect medicine, no matter powder or liquid.

The filtered air is blown into plenum box by low-noise fan through primary efficiency filter, and then blown out through HEPA filter, so as to protect operator and medicine from contamination. 10% recirculating air is exhausted from operation space to maintain negative pressure.

Design Reference:

China GMP (2010)

EU GMP

FAD and latest cGMP Guideline

Differential Pressure Meter is installed to monitor the state of filter; DOP port is available to test the integrity of filter



洁净层流车是一种提供可移动的局部无尘无菌环境的层流型空气净化设备，应用于医药卫生、科研电子等洁净室内的物品搬移。内部可以做框架，放置托盘可根据需要定制水平层流或垂直层流DOP测试口可有效配合检测过滤器的完整性可选配压差显示、风速显示及洁净度实时监测

Clean Laminar Cart is a purification device which can provide a local particle-free sterile environment. It's used to remove materials in cleanrooms. Support frame can be set inside to put trays. Vertical and horizontal laminar are optional according to requirements. DOP port is available to test the integrity of filter. Differential pressure, air velocity display and cleanliness real-time monitoring are optional.

医用不锈钢柜产品

Medical Cabinet and Stainless Steel Products



器械柜
Tools Cabinet



麻醉柜
Anesthetist Cabinet



药品柜
Medicine Cabinet



洗手池
Hand-Washing Sink



气体终端
Gas Terminal

洁净室灯具系列 Cleanroom Light Series



吸顶式洁净灯：
主要应用于洁净室普通区域
Ceiling-type Light:
mainly used in common area



嵌入式洁净灯：嵌入式安装，上
更换检修，符合GMP净化要求
Recessed Light: Recessed, top-
maintenance, conforms to GMP.



防爆洁净灯：主要应用于洁净室内
防爆区域
Explosion-proof light: mainly used
in explosion-proof area of cleanroom.



泪滴式洁净灯：主要安装于高洁净度
等级厂房满布式FFU边框，减少对气
流流型的影响。
Tear-drop Light: mainly installed under
FFU in high cleanliness cleanroom, less
impact on air distribution



LED灯具：新型照明灯具，厚度小，亮度大，节能效果好，亮度、色温可调，可直接贴装到洁净室吊顶板上，安装方便。
LED Light: New-type Light, thin, high illumination, energy-saving, illumination and color temperature adjustable.



不锈钢插座排，嵌入围护结构内，表面齐平，易清洁，带接地系统，有效减少洁净室内开孔，安全方便。
S.S Socket Collection Panel, recessed in flush with partition panel, easily clean, with grounding system, safe and convenient



中天道成

Success Way
Clean Tech

中天道成(苏州)洁净技术有限公司

Success Way Clean Technology Co., Ltd.

洁净室测试仪器系列

Cleanroom Measuring Instrument Series



粒子计数器:
2.83-100L/min Particle Counter



风量罩
Air Hood



测试组合套装: 温湿度、照度、噪音、压差
Measurement Kit: T&RH, Illumination, Noise,
Differential Pressure.



浮游菌采样器
Floating Bacterial Sampler

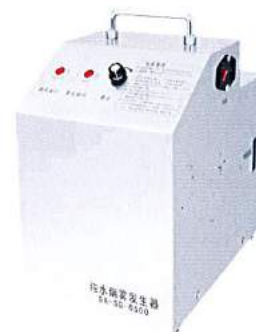

烟雾发生器
Aerosol Generator



扫描光度计
Scanning Photometer



净化空调系统:

Air Handling Unit (AHU)

组合式空调机组: 根据净化需求设置不同的功能段
Modular Air Handling Unit: Different functional section
is determined according to purification requirements.

工程业绩(部分)

Achievements (Partial)

吉林大学第一医院外科病房设计工程
山东大学第二医院外科病房设计工程
中南大学湘雅医院病房楼设计工程
北大国际医院综合楼设计工程
北大国际医院综合楼设计工程
重庆第二人民医院净化工程
潍坊市人民医院净化工程
广东医学院附属医院净化工程
广东省人民医院净化工程
广州中医药大学附属第一医院净化工程
深圳龙珠医院手术部及ICU等空气净化工程
万安县人民医院供应室及产房净化装饰工程
永新县中医院手术部及供应室净化装饰工程
重庆市公共卫生医疗救治中心手术室和重症监护室设计施工总承包
昆明东川祥和医院手术室、ICU等净化工程
吉安县人民医院ICU洁净装饰工程
永新县中医院手术部及供应室净化装饰工程
江西省新余市妇幼保健院手术室净化装饰工程
罗湖区人民医院医技楼生殖医学中心净化空调工程
淮南朝阳医院手术室洁净系统安装工程
广州白云山明兴制药SPF动物实验室空气净化工程
广州医学院第一附属医院制药车间净化工程
深圳平乐骨伤科医院制剂室固体制剂生产车间净化工程
昆明市儿童医院南市区医院静脉用药集中调配中心净化装修工程
博泰生物技术研发中心装修工程
深圳先进技术研究院西丽大学城园区特种净化实验室装饰工程
深圳华粤宝电池有限公司碧岭厂房机电及洁净系统安装工程
孚能科技(赣州)有限公司1#厂房车间空调净化系统
弗雷公司深圳高新园区新厂房净化装饰工程
帝豪电子(扬州)有限公司厂房洁净工程(一期)
宁波鑫丰泰电器有限公司洁净车间装饰安装工程
深圳海量三期净化间建设工程
广东北电实验机房及办公室装饰工程
中国计量科学研究院实验室净化工程